

MAX. WHEEL LOAD = 20.0 tons  
 BUFFER FORCE = 10.0 tons at level +0.80  
 TRACTIVE FORCE = 3.0 tons PER WHEEL  
**WHEEL LOAD DIAGRAM FOR 30T**  
 FOR OPEN CRANE AREA  
 SCALE 1:100

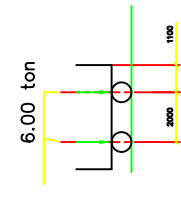

MAX. WHEEL LOAD = 6.0 tons  
 BUFFER FORCE = 3.0 tons at level +0.80  
 TRACTIVE FORCE = 3.0 tons PER WHEEL  
**WHEEL LOAD DIAGRAM FOR 10T**  
 FOR OPEN CRANE AREA  
 SCALE 1:100



SEC. B-B

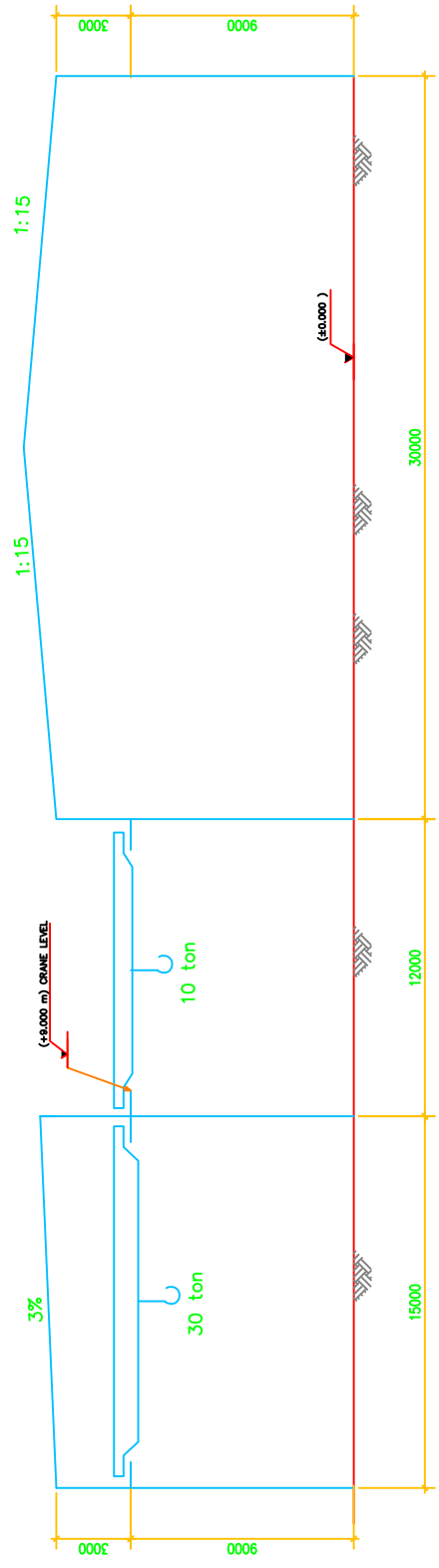

SEC. A-A

|                                  |  |
|----------------------------------|--|
|                                  | CAIRO UNIVERSITY<br>FACULTY OF ENGINEERING<br>FOURTH YEAR CIVIL<br>STEEL PROJECT |
|                                  | UNIT #:<br>INDUSTRIAL FACTORY  |
| DRAWING TITLE:<br>CROSS SECTIONS | DATE:<br>  |
| SCALE:<br>                       |  |